

Measures without tolerance according to UNI ISO 2768-mk

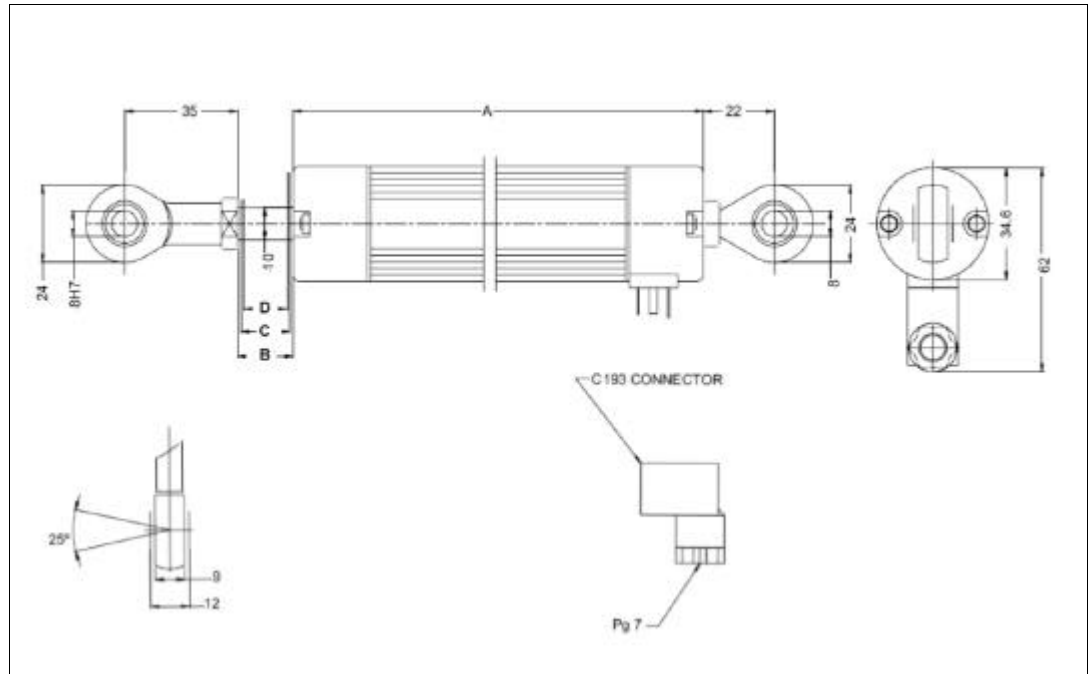

TECHNICAL FEATURES AND POSSIBLE CONFIGURATIONS

- Weight.....:please refer to the table on page 2
- Standard stroke.....:please refer to the table on page 2
- Anodised aluminium housing with nylon 66 with fiber glass closing flanges.
- Low Noise Output from resistive element in conductive plastic.
- Fixing with movable metallic feet.
- Sealing.....:standard IP65 ; sealed - (°)
- Linearity.....:± 0,05% (please refer to the table on page 2)
- Repeatability.....: < ± 0,013mm
- Resolution.....:infinite
- Max operating speed.....: 5 m/s
- Starting force.....:standard <=10N
- Impact resistance.....:10 G (*)
- Vibration resistance.....:40 G (**)
- Operating temperature.....: -30 ÷ 100 °C
- Storage temperature.....: -50 ÷ 120 °C
- Power supply.....:60V max
- Max consumption.....:3W - 10W
- Insulation.....:residue current < 5 µA @ 500V per 1 minute
- Current (resistance).....: <= 10mA
- Current (cursor).....: <= 1mA (recommended <1µA)
- Output smoothness.....: < ± 0.1% against input voltage
- Operating life.....: > 100x10⁶ Cycles
- Electrical connections by orientable connector C193.

(°) IP accord. to CEI EN 60529, EN 60529, IEC 529 Standards

(*) Impact resistance accord. to IEC 68-2-6:1982 Standard

(**) Vibration resistance accor. to IEC 68-2-29:1968 Standard



ELCIS s.r.l.
Via Rosa Luxembourg 12/14 10093 COLLEGNO (TO) ITALY
Phone: +39 011 71577/78 a.r.

* <http://www.elcis.com>
* e-mail: info@elcis.com
* Fax: +39 011 712613

USEFUL STROKES AND TOTAL LENGTHS*

	50	75	100	130	150	175	200	225	250	275	300	350	375	400	425	450	500	600	750	900	-
Total travel (C) mm	53	78	103	133	153	178	204	229	254	279	304	354	380	406	432	457	508	609	762	914	-
Active travel (D) mm	51	76	101	131	151	176	202	227	252	277	302	352	378	404	430	455	506	607	760	912	-
Resistance ±20% kOhm	5,0	5,0	5,0	5,0	5,0	5,0	5,0	5,0	5,0	5,0	5,0	5,0	5,0	5,0	5,0	5,0	5,0	5,0	10,0	10,0	-
Linearity ±%	0,05	0,05	0,05	0,05	0,05	0,05	0,05	0,05	0,05	0,05	0,05	0,05	0,05	0,05	0,05	0,05	0,05	0,05	0,05	0,05	-
Mechanical tr.(B) mm	59	84	109	139	159	184	210	235	260	285	310	360	386	412	437	463	518	619	772	924	-
Total lenght (A) mm	166	191	216	246	266	291	318	343	368	393	419	484	509	534	561	609	673	799	983	1174	-
Weight g	300	325	350	375	400	450	475	500	525	550	600	650	675	700	725	750	800	950	1125	1280	-

MEASUREMENT CIRCUIT AND ELECTRICAL CONNECTIONS

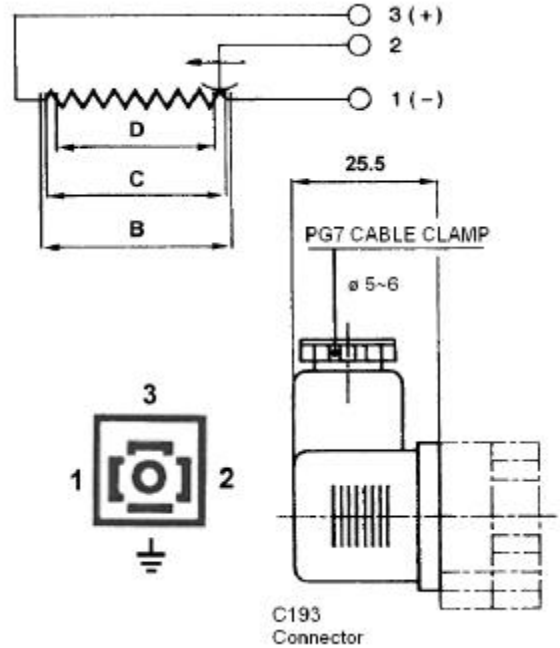
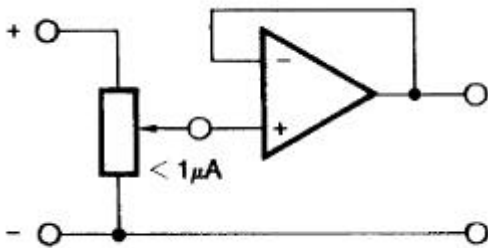

NOTE:
 The published technical data are applicable only when the transducer is used correctly and in accordance with the user manual/instructions.
 The linear position transducer must be used as voltage divider with a maximum current in the wiper contact of 1 μ A.
 Should the system downstream require more current, further circuitry will be required.

ORDERING INFORMATION

(50)(75)(100)(130)(150)(175)(200)
 (225)(250)(275)(300)(350)(375)(400)
 (425)(450)(500)(600)(750)(900)(-)

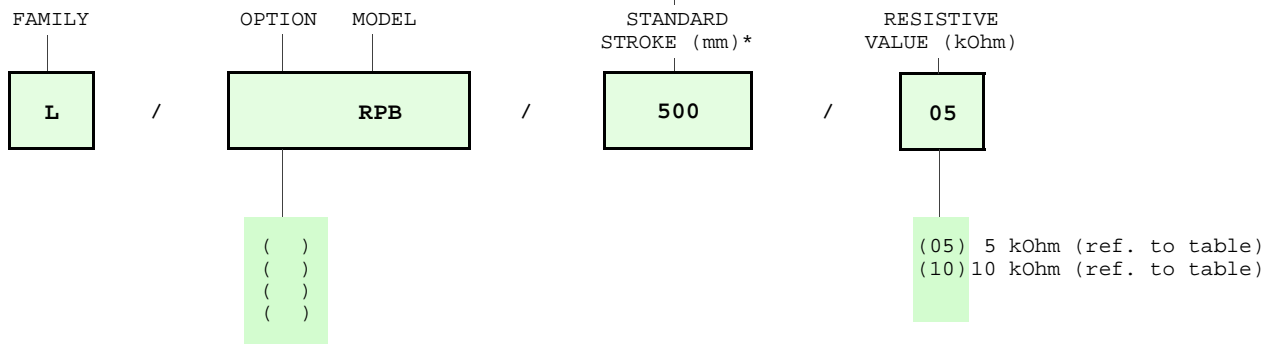

Product manufactured according to UNI EN ISO 9001:2000, supplied with CHECKING and CONFORMITY declaration with CE mark and with TWO (2) YEARS WARRANTY starting from delivery date.

(*) Other lenghts upon request.

ELCIS company has the right to make any changings without previous notice.

data sheet IL008 EOA page:04.RPB

2/2



ELCIS s.r.l.
 Via Rosa Luxemburgo 12/14 10093 COLLEGNO (TO) ITALY
 Phone: +39 011 715577/78 a.r.

* <http://www.elcis.com>
 * e-mail: info@elcis.com
 * Fax: +39 011 712613

COPYRIGHT by ELCIS - Collegno (TO)